

# Tram Grade Separation Projects

## Marion Road and Cross Road Level Crossing Removal Project

**Works notification – August to September 2025**

### We're raising the tram line over Marion Road and Cross Road to get traffic moving

This notice provides information about important upcoming changes to local access and works planned in your area throughout August and September 2025.

### What's happening

From Saturday 2 August 2025 we are starting major construction of the Marion and Cross Road's overpass between Clayton Avenue and Lindsay Street, Plympton.

General work activities across the project area will include:

- ongoing intersection upgrades
- ongoing service relocation

The following activities will occur within the tram corridor:

- removing existing tram infrastructure, including level crossings, tram stops, overhead equipment and tram tracks
- earthworks
- piling activities
- building the new overpass, including use of a crane.

We will be working across five work zones to construct the new overpass. Please refer to the work zone map and activity table over the page that outlines the activities planned across August and September 2025.

### How this affects you

**In addition to standard day works, we will be working during the day and night from Saturday 2 August 2025 for up to three weeks.** Day works, with intermittent periods of night works, will continue throughout September 2025. Advance notice will be provided to adjacent residents prior to night works.

#### Hours of work

Day works  
Monday to Sunday  
7am – 7pm

Night works  
Monday to Sunday  
7pm – 7am

#### Where

- Along Marion Road and Cross Road, near the level crossings.
- Along the tram corridor on Glengyle Terrace, Pleasant Avenue, Wattle Terrace and Lindsay Street.

#### More information

Visit  
[tgsp.sa.gov.au](https://tgsp.sa.gov.au)

Email  
[info@TGSPAlliance.com.au](mailto:info@TGSPAlliance.com.au)

Call 1300 916 976



Australian Government

**BUILDING AUSTRALIA**



Government  
of South Australia

Department for Infrastructure  
and Transport







Delivered by



Tram Grade  
Separation  
Projects  
Alliance

## Work zone map and activity table (August to September 2025)



Zone		Locations	Activity
1		Park Terrace to Acacia Street	<ul style="list-style-type: none"> <li>cutting and removing existing rail</li> <li>welding new sections of rail together</li> </ul>
2		Lindsay Street and Acacia Street to Cross Road	<ul style="list-style-type: none"> <li>removing existing tram stop and platform</li> <li>installing precast walls and backfilling</li> <li>installing bridge columns and crossheads</li> <li>installing bridge beams and deck</li> </ul>
3		Cross Road to Marion Road	<ul style="list-style-type: none"> <li>removing level crossings and boom gates</li> <li>removing Stop 10 Marion Road and platform</li> <li>installing bridge columns and crossheads using a crane</li> <li>installing bridge beams and deck using a crane</li> </ul>
4		Marion Road to Clayton Avenue and Mavis Avenue	<ul style="list-style-type: none"> <li>installing bridge columns and crossheads using a crane</li> <li>installing bridge beams and deck using a crane</li> </ul>
5		Mavis Avenue to New Street	<ul style="list-style-type: none"> <li>cutting and removing existing rail</li> <li>welding new sections of rail together</li> </ul>
Intersection Upgrades		Anzac Highway and Marion Road Marion Road and Cross Road	<ul style="list-style-type: none"> <li>ongoing work to install new turn lanes, kerbs and paths</li> </ul>

## What to expect

You may experience periods of high noise while we remove existing infrastructure such as the level crossings, tram stops, overhead equipment and tram tracks. There will also be some noise associated with other general activities.

We will work with directly affected residents to understand their needs and minimise the impact as much as possible.

## Night works

We are working outside of daytime hours to fast-track construction of the overpass and ensure tram services recommence late January 2026, in time for the return of school.

Night works are also necessary for safety reasons when working next to roads when undertaking overpass works over Marion Road and Cross Road.

**There will be intermittent periods of night works for the duration of the project. Advanced notice will be provided to adjacent residents prior to night works starting.**

We will do our best to schedule the noisiest activities during the day or early in the night shift, where possible.

## Tree and vegetation removal

Some further tree and vegetation removal will occur alongside the main overpass construction work site. Impacts to trees will continue to be minimised wherever possible during construction.

For further information on how we are managing tree and vegetation removal, and how we are offsetting the removals, please visit our *Vegetation Fact Sheet and Landscape Plans* on the project website.

## Haulage routes

To construct the new overpass, work vehicles (including heavy vehicles) need to access the tram corridor using local streets.

Haulage routes were selected after careful consideration and planning to reduce impacts on the local community as much as possible.

## Temporary access changes

To keep everyone safe, intermittent and long-term local side road closures and detours will be implemented as necessary throughout the construction program.

Local access will change shortly in the following areas:

- Glengyle Terrace
- Pleasant Avenue
- Wattle Street
- Changes to cyclist access in the area

For more information on haulage routes and local access changes, please refer to the *Marion Road and Cross Road Level Crossing Removal Project Temporary Local Access Changes* fact sheet available on the project website.

To keep everyone safe, speed and lane restrictions will be in place. Please observe onsite signage and follow the directions of traffic controllers.

## Temporary main road closure

**Marion Road (between Cross Road and Turner Avenue) will be closed at night only between Saturday 2 August 2025 and Friday 8 August 2025. The closures will occur between 9pm and 5am.**

**Cross Road (between Herbert Street and just west of the tram crossing) will be closed at night only between Monday 11 August and Wednesday 13 August. The closures will occur between 9pm and 5am.**

Detour maps for the Marion Road closure and the Cross Road closure are provided over the page.

Advance notice via VMS (Variable Message Signs) will be provided prior to any full road closures.

Please follow the onsite signage for detour and pedestrian access around the work area.

We will also need to temporarily close Marion Road and Cross Road at night and on some weekends intermittently for the duration of the project to safely carry out some overpass construction activities.



## Temporary Marion Road closure detour map (Saturday 2 August – Friday 8 August 2025 at night only)

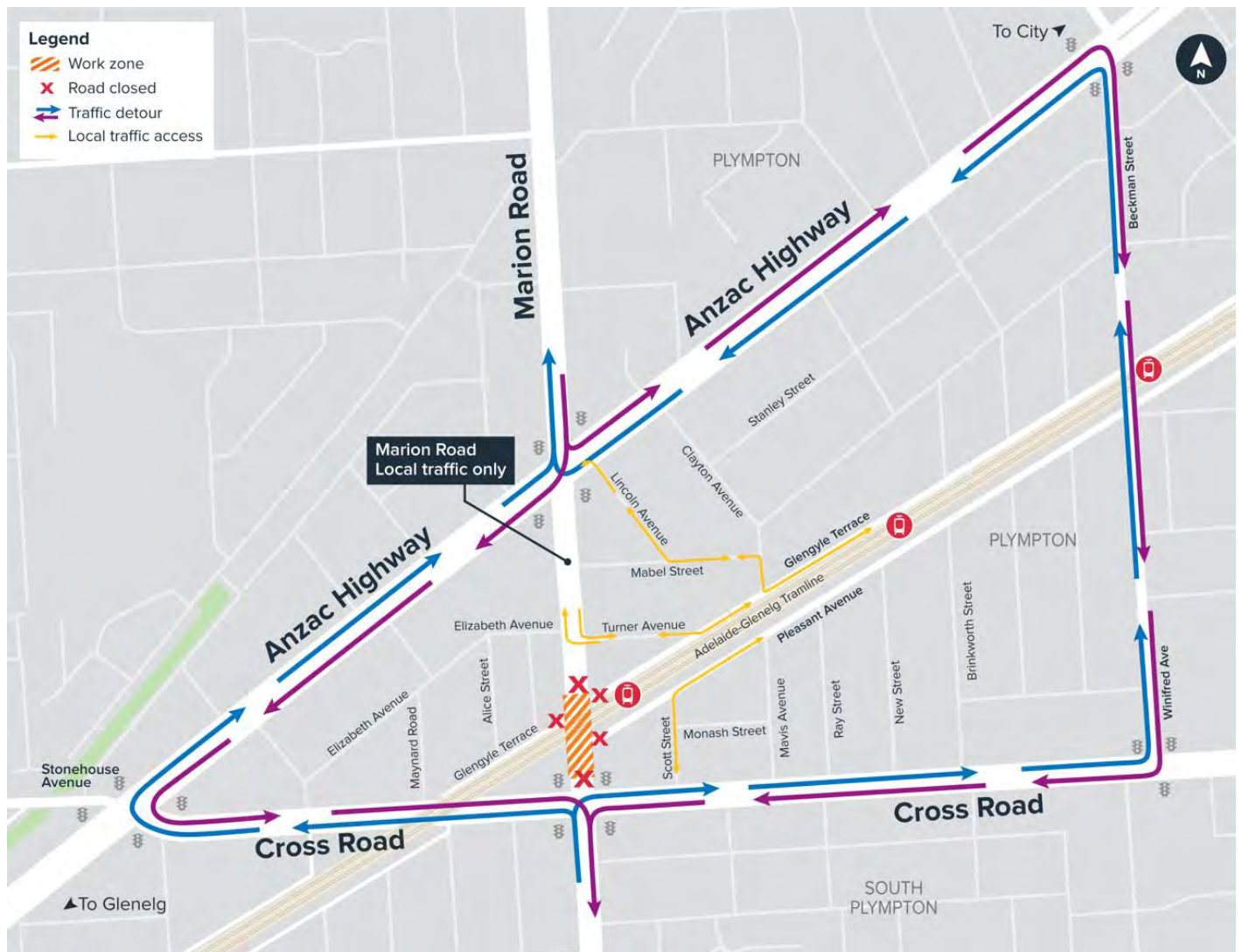

## Temporary Cross Road closure detour map (Monday 11 August and Wednesday 13 August 2025 at night only)

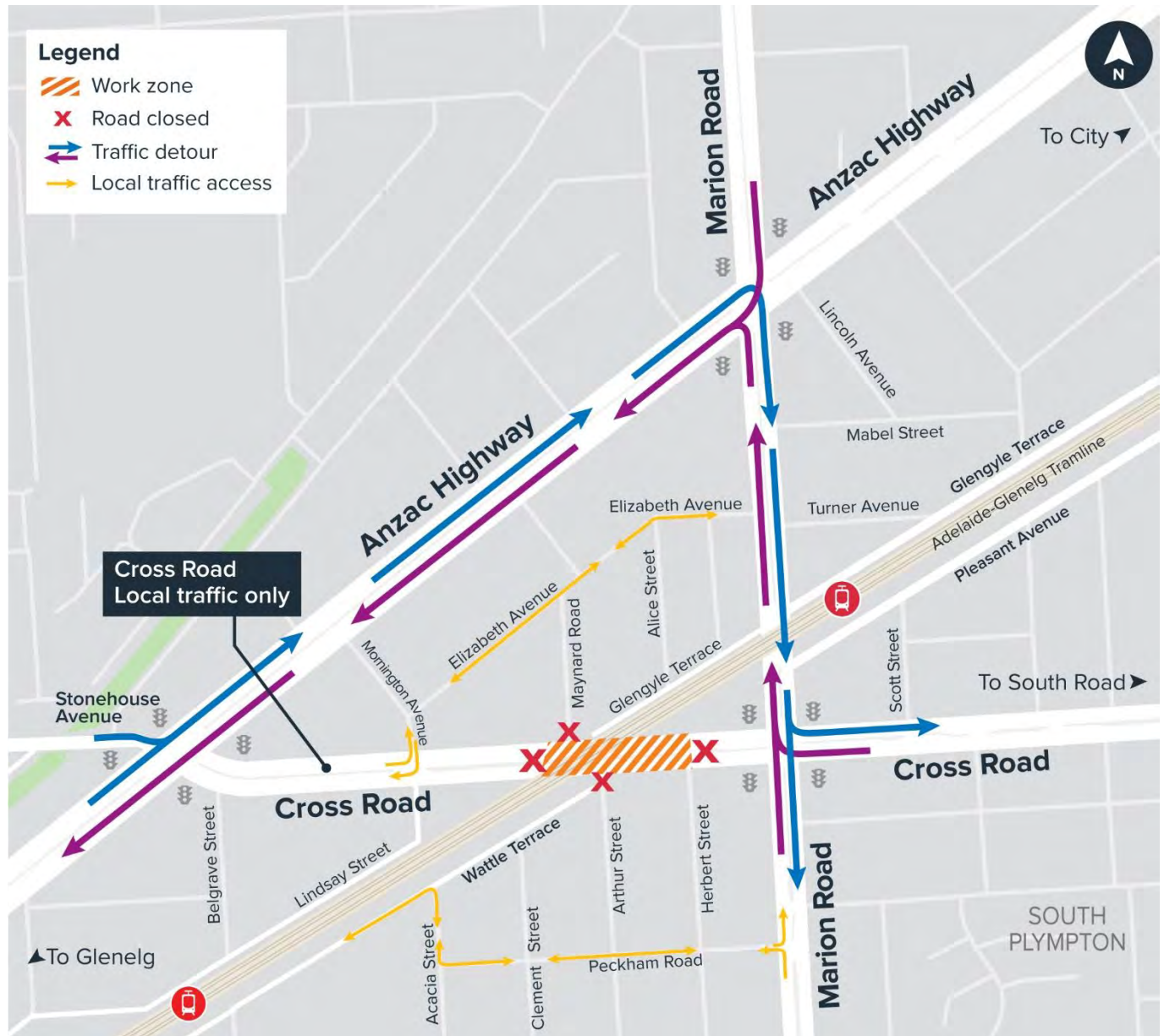

### Stay up to date

Join our mailing list to keep updated about upcoming early works, events, information sessions and exciting news about the project.

To register please:

- visit our website at: [tgsp.sa.gov.au](https://tgsp.sa.gov.au)
- scan the below QR code
- email [info@TGSPAlliance.com.au](mailto:info@TGSPAlliance.com.au)
- call 1300 916 976



Major construction will be complete in late 2025.

Tram services will recommence by the end of January 2026, in time for the return of school.

Finishing works (such as landscaping, installation of new lighting and wayfinding signage) will continue through to mid-2026.