

# Welcome to our Sewing Studio

The City of West Torrens is pleased to provide a place where people can share their passion for sewing, have fun in a relaxed setting and meet like-minded people.

*Happy sewing!*



City of  
**West Torrens**  
Between the City and the Sea



The City of West Torrens Sewing Studio meets twice a week at Plympton Community Centre, 34 Long Street, Plympton.

- Day group - 11am - 2pm each Wednesday.
- Evening group - 6pm - 9pm each Monday.

A car park at the rear of the centre is provided.

## Group courtesy and worksite safety

### Please:

- Respect others privacy, possessions, beliefs and personal space.
- Assist with set-up, pack-up and house-keeping.
- Use respectful language and be prepared to share your skills and knowledge.
- Remember that participation is a privilege and not a right.
- Follow safe work instructions and procedures and tell coordinators about hazards and safety issues. *Please note: due to safety reasons, please do not bring children to the group.*
- In the event of hostile, aggressive or inappropriate behaviour, people may be asked to leave a session by Council staff or coordinators. In some instances they may be requested not to attend sessions for longer periods.

## Bring with you

- A project and sewing aids. Ensure that scissors and other valuable items (in particular) are labelled with your name.
- Your own fabrics, threads and patterns. Some donations from the community are received from time to time. Please help yourself to these and remember that others may wish to use these as well.
- Some hand sewing such as hemming, mending or button replacement. Sometimes the numbers of participants exceeds the numbers of machines. In instances such as these, machines are allocated at 35 minute intervals.
- Your own food, snacks and drinks. Please wash, dry and put away any crockery and cutlery that you may use.

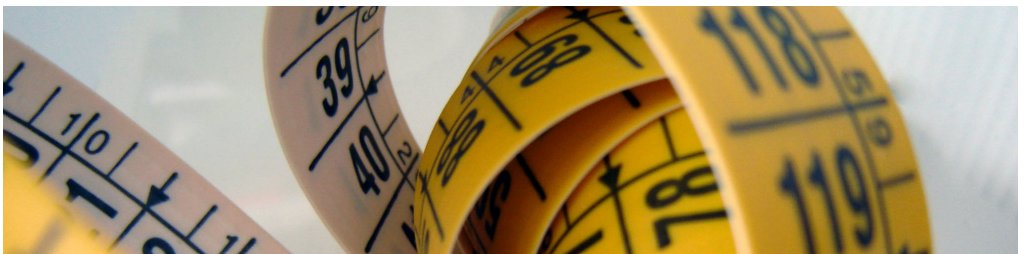



## Sewing machines

- Provided and serviced by Council.
- Please treat with care and assist with setup and packup.
- For use with light weight fabrics only. Please do not use heavy upholstery fabrics as these will blunt and/or break the needles.
- Over-lockers are provided for use by people who are skilled operators, or under guidance of coordinators if they are available to assist.

## Roles of coordinators, volunteers, visitors and Council

- Coordinators kindly volunteer their time and expertise to assist the group. This is a self-help group so please be mindful that coordinators work on their own projects during these sessions as well; they are not teachers.
- Council may arrange for visitors or specialist tutors to join the group on occasions, particularly if enough people wish to extend particular sewing skills or knowledge. Please be respectful of these people.
- Council provides a facilitator to support the group in being self-sufficient. This officer can provide advice and support to the coordinators and will arrange training, subject to available budget.

## More information

Contact the Community Development Team on 8416 6333 (during business hours) or email [csu@wtcc.sa.gov.au](mailto:csu@wtcc.sa.gov.au)



# Plympton Community Centre floor plan

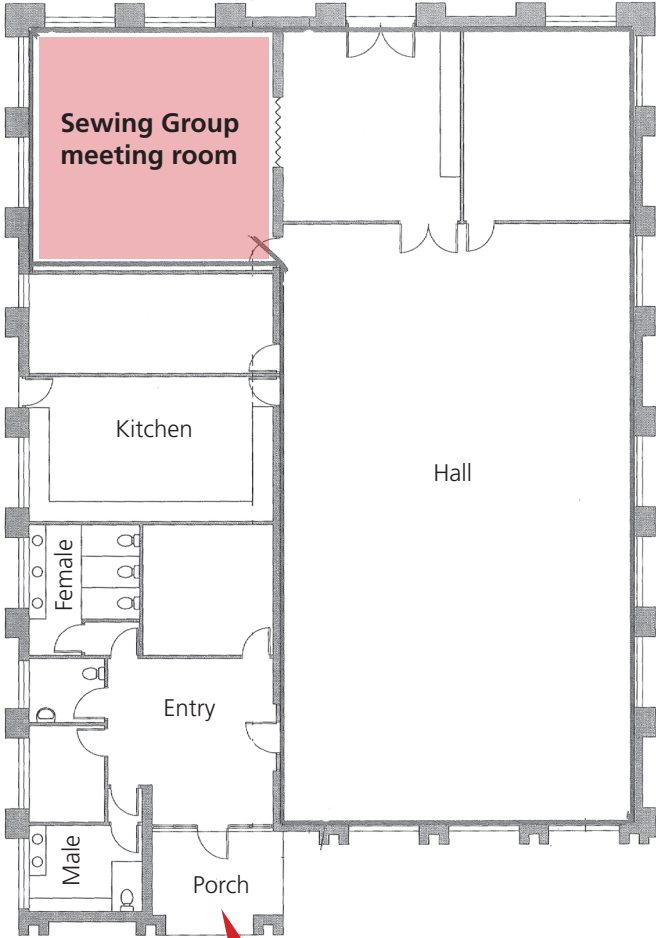

**Entrance to Plympton Community Centre**

Long Street